

# B. W. Wells Stewardship Award

## Mason Wallace Park Project Summary

On October 12, 2022 we received the happy news that our application was approved. Our group lost no time scheduling a meeting to celebrate and get to work.

Prior to our October 23<sup>rd</sup> meeting, Dave Molinaro and Stephen James were in contact with Mecklenburg County Parks and Rec staff who were excited to assist us in this project. They marked out the plot, brought in soil amendments, requested a utility check, and tilled the soil so we would have fertile ground for our new native plants.

Our application originally proposed using a native plant nursery in western NC; however, transportation for getting the plants to our site was problematic. After receiving several suggestions from other committee members, Stephen James contacted Lisa Tompkins (It's Elemental Landscape Design) at Carolina Heritage Nursery in Waxhaw. With a few minor revisions, she was able to provide and deliver all the plants we needed for the project. All plants were currently available except the *Asclepias Tuberosa* (Butterfly Weed), which will be delivered in the spring. A plot map is attached.



Plot #1 Revised Plant  
Design.pdf

We scheduled our planting date for Saturday, November 19<sup>th</sup>, and notified volunteers of the upcoming event. Again MCP&R provided valuable help in getting mulch delivered to our site as well as placing several large decorative stones in the plot.

A few days prior to planting, Dave Molinaro, using Stephen James's well devised planting diagram, put flags where each plant should go and set up the staging area for delivery. He also prepared legends for volunteers to match the letters on the flags with specific plants. Lisa Tompkins, of Carolina Heritage Nursery, was there bright and early on planting day. We promptly unloaded the truck and began working.

We had eleven volunteers who were there to help all or part of the morning, and we got 89 native plants snuggled into their new home and mulched for the winter. Hopefully, they will be sending down roots so we will have a great display next Spring. We will also plant the nine additional Butterfly Weed plants at that time. Here is a link to pictures from our day of planting: <https://davidmolinaro.smugmug.com/Revised-Native-Plant-Planting->

We believe the \$900 grant money was well spent. Attached are copies of our checks for plants which used all but 88 cents of the grant money. Dave Molinaro, and his spouse, Cricket Weston, provided water and snacks for our volunteers.

<https://mail.google.com/mail/u/0?ui=2&ik=1580cbaaec&attid=0.1&permmsgid=msg-f:1749124566356897425&th=184623869d9cae91&view=att&disp=inline>

[https://mail.google.com/mail/u/0?ui=2&ik=1580cbaaec&attid=0.1&permmsgid=msg-a:r-624787446719336680&th=184cf283247e71f6&view=att&disp=inline&realattid=f\\_lb5gvo814](https://mail.google.com/mail/u/0?ui=2&ik=1580cbaaec&attid=0.1&permmsgid=msg-a:r-624787446719336680&th=184cf283247e71f6&view=att&disp=inline&realattid=f_lb5gvo814)

Our group was fortunate to receive recognition from Lisa Tompkins on her Carolina Heritage Nursery Facebook page as well as posts on Facebook, Twitter, and the MORA website from Tricia Tam, who handles media for MORA. Copies of these are shown on the following pages.

Facebook post by Lisa Tompkins:



Carolina Heritage Nursery is in Charlotte, North Carolina.

November 19 at 9:53 AM · 🌐



Grateful for customers such as these, neighbors of Mason Wallace Park who banded together to make this corner of the world a better place. With native plants, of course. They designed, organized, applied for and received grant monies and staged the planting of a Pollinator Garden (with the help of Mecklenburg County Parks and Rec, I believe). I rounded up and delivered the plants. Today, they're planting. People like this make the world a better place. [#pollinatorgardens](#) [#goodneighbors](#) [#nativeplants](#)



[Article on MORA website:](#)

# Native Plants take root in Mason Wallace Park

News



Mason Wallace Park welcomes the first of three Native Plants Plots. The idea for the plots sprang after the [park's revitalization celebration](#) in May of this year. And Mason Wallace Park Advocates (MWPA) set out to make it happen.

**Stephen James** designed the landscape plan for the 125'x10' area to include nearly 100 individual plants—across 11 different species—as well as several small boulders. This first plot is a sun-loving site, stretching along the left side of the back parking lot. MWPA worked with **Lisa Tompkins**, owner of [Carolina Heritage Nursery](#), to source the species they desired.

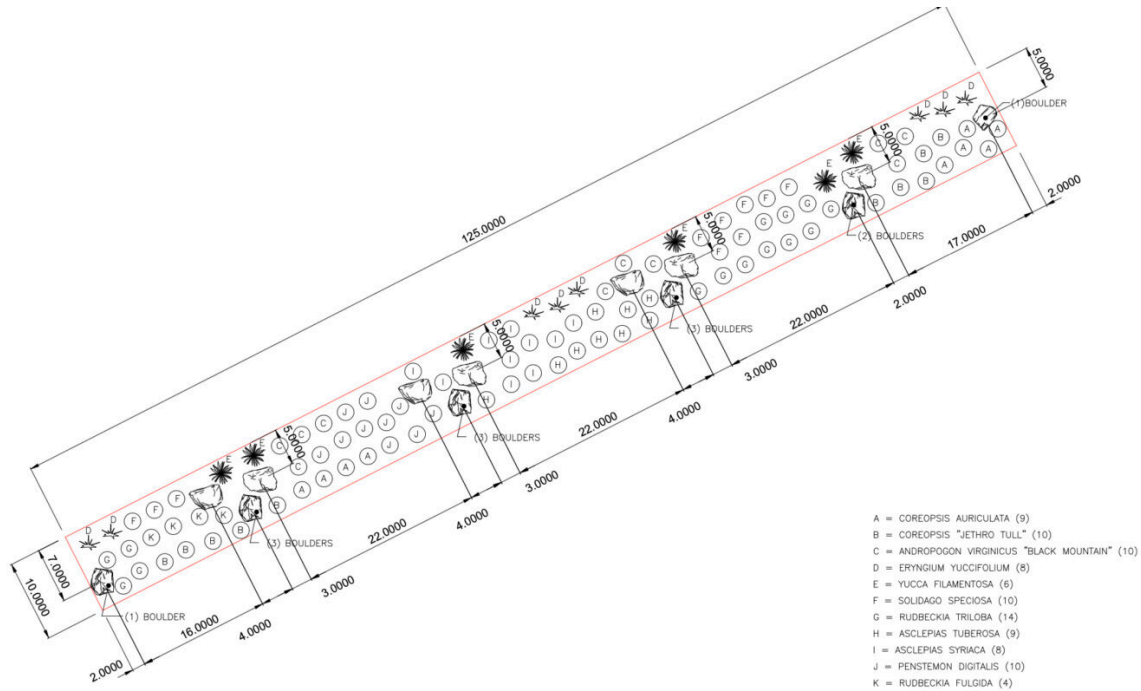

*Click to expand.*

“Mecklenburg County Park and Recreation’s Horticulture Manager, **Phillip Clarkson**, has been so supportive of the project,” said **Dave Molinaro**, leader of MWPA. The County helped prepare the site for planting and also provided mulch.



With the site and materials ready, MWPA rallied volunteers for a morning work session on Saturday, November 19. Lisa delivered a truckload of healthy plants,

and in under two hours, the volunteers got all of the plants in the ground and mulched.





## **The First 3-Year Life Cycle**

If you go by the park, you will see a large area of mulch with boulders and a series of tiny flags sticking up. Watch your step! Those plant babies are in the ground. During the first year, they'll sleep. In Year 2, they'll creep. And in Year

3, they'll leap. The plot design above details the species' scientific names and locations, while the collage below shows how the matured plants' blooms may look in their future glory.



## **Funding for the first plot**

MWPA secured a grant from the [B.W. Wells Stewardship Fund](#), a North Carolina Native Plant Society (NCNPS) program that supports community projects like native plant garden installations and habitat restorations. (NCNPS also helped fund Charlotte Wildlife Stewards' planting of native wetland plants at the Chantilly Ecological Sanctuary a few years back.) We will keep you informed of future opportunities to contribute time and treasure to Plots #2 and #3.

## **Thank you**

Thank you to Mason Wallace Park Advocates, community volunteers, Mecklenburg Park and Recreation, Lisa Tompkins of Carolina Heritage Nursery, and everyone championing the project. Work will continue next spring with the installation of shade-loving Plot #2.





\*\*\*\*\*

Please accept our sincere thanks for sponsoring our project.